

Hotelmodus/alleen internet radio – (Airplay, Spotify, Bluetooth, Line in) uitschakelen op WHD WLAN-luidsprekers / AirBridge

Download de "Airlino-App" van onze Bluetooth / WLAN-chipleverancier:

Apple: <https://apps.apple.com/de/app/airlino/id1290777489>

Android: <https://play.google.com/store/apps/details?id=airlino.lintech.de.airlino&hl=de&gl=US>

Start de Airlino-App en druk op +

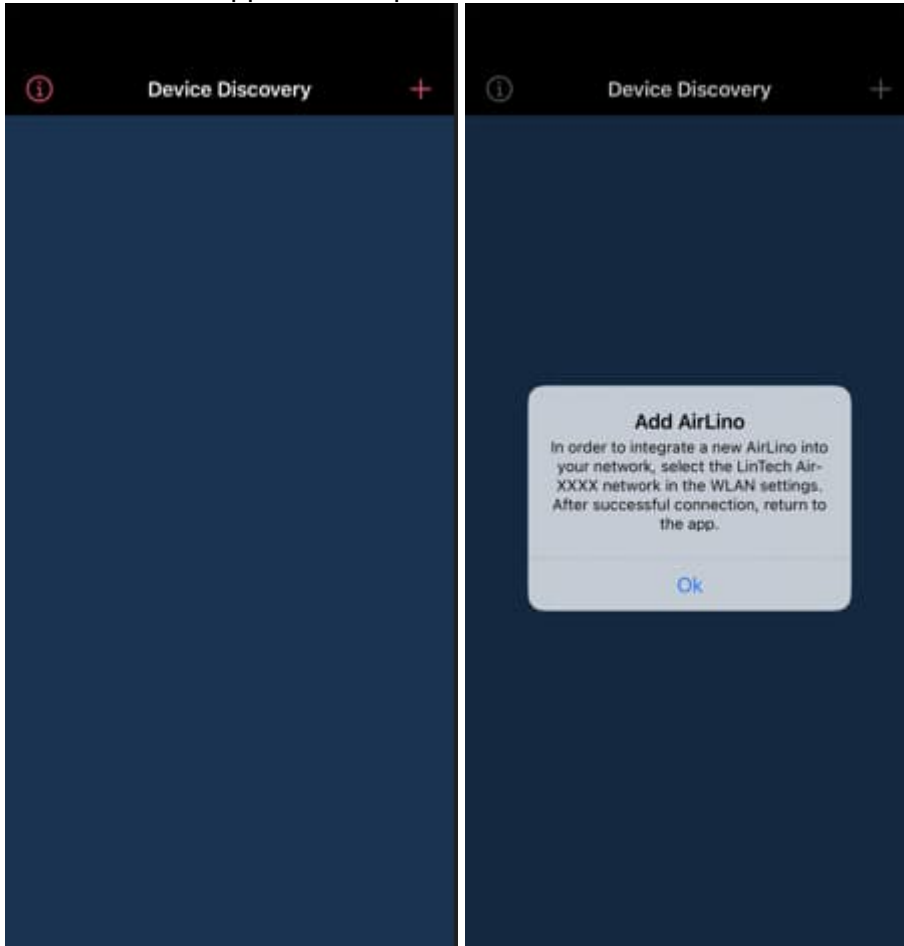

Ga naar de WiFi instellingen van de Smartphone en verbind WHD Air-Bridge

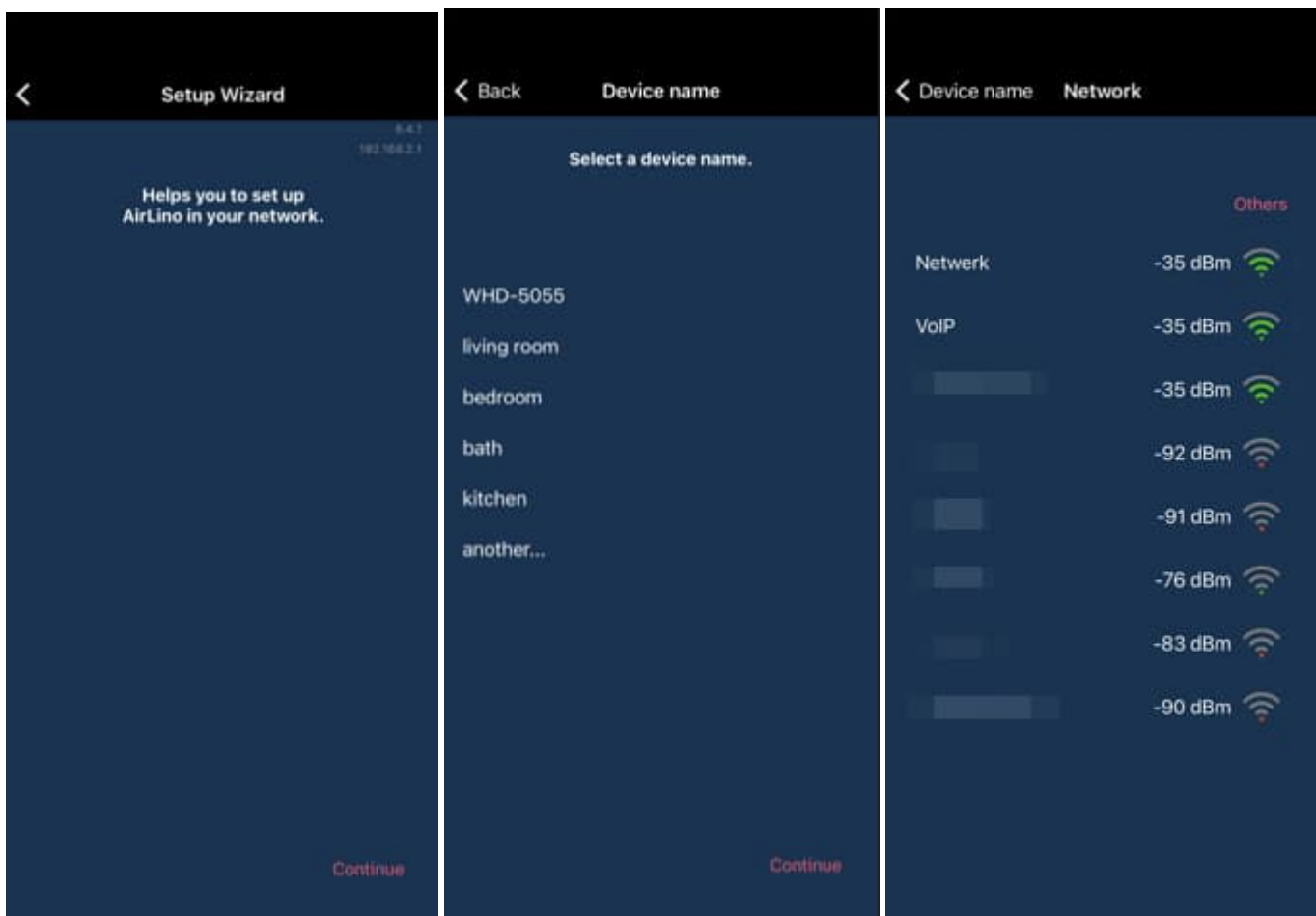
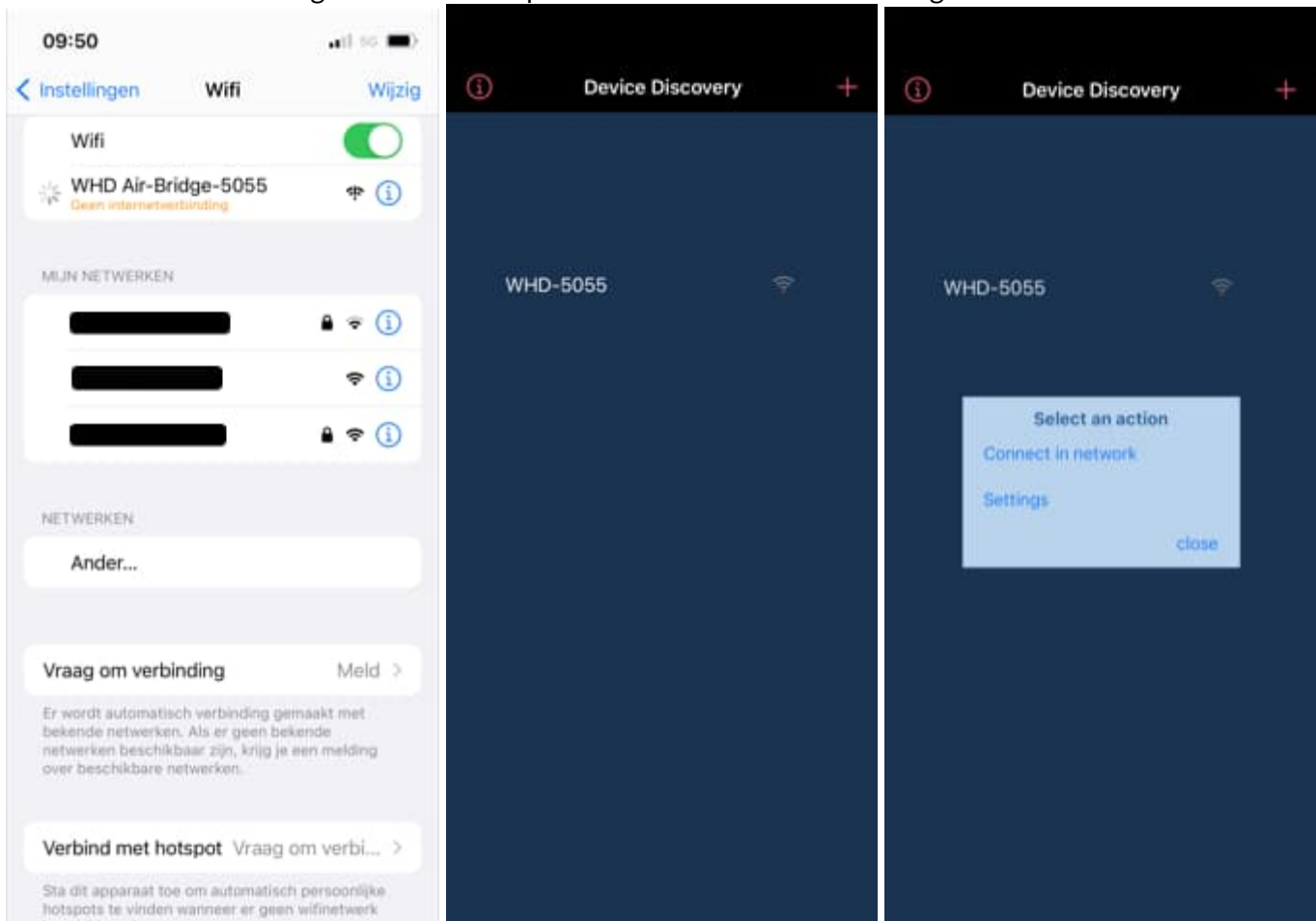

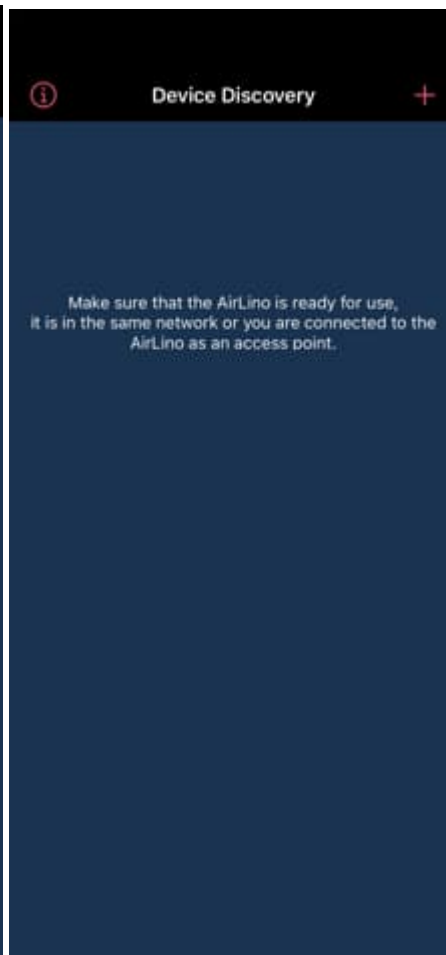
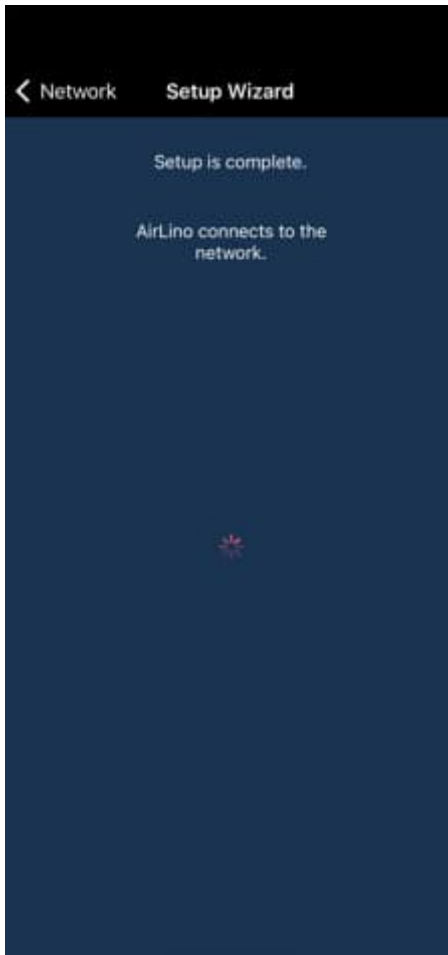

Selecteer de gewenste WHD-luidspreker / de gewenste AirBridge uit de lijst, hier bijv. „WHD-5055“

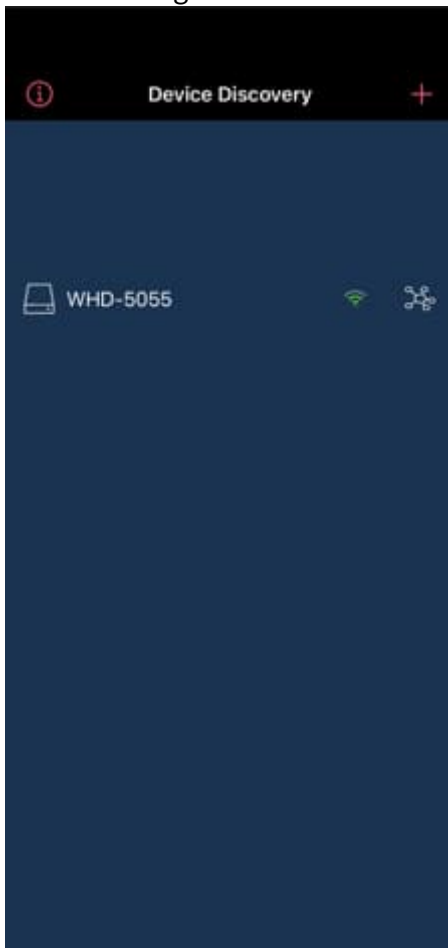

Tik op de instellingen in de rechterbovenhoek

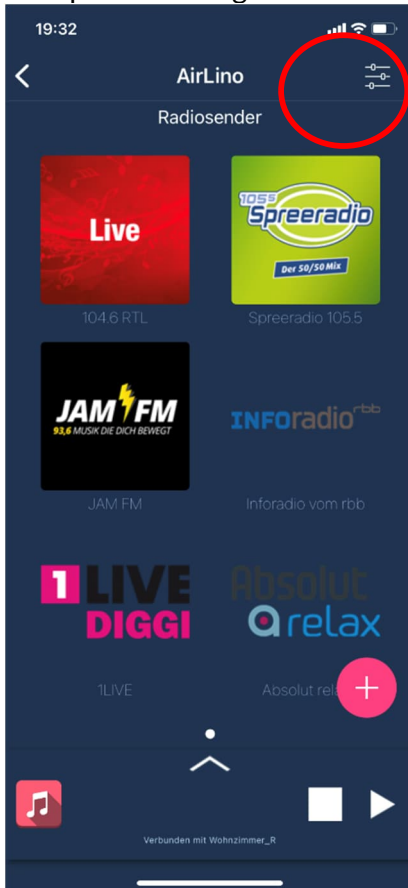

Voer eerst een Firmware update uit

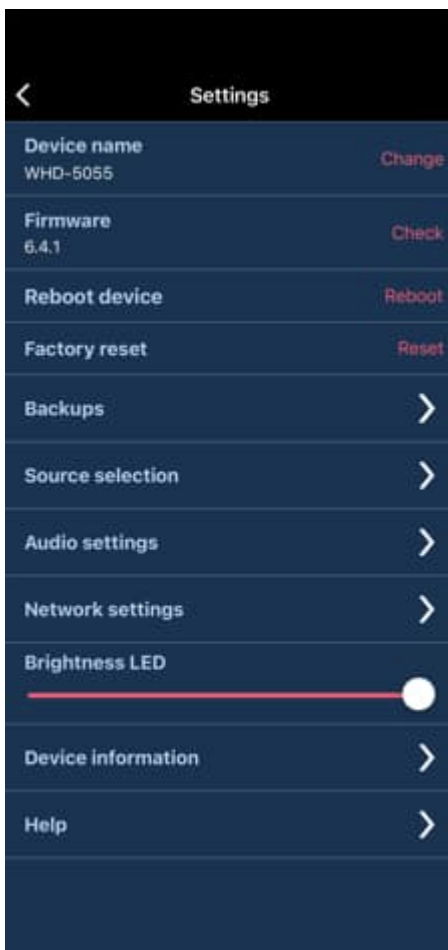

Tip op „Quellenauswahl“ (Source selection)

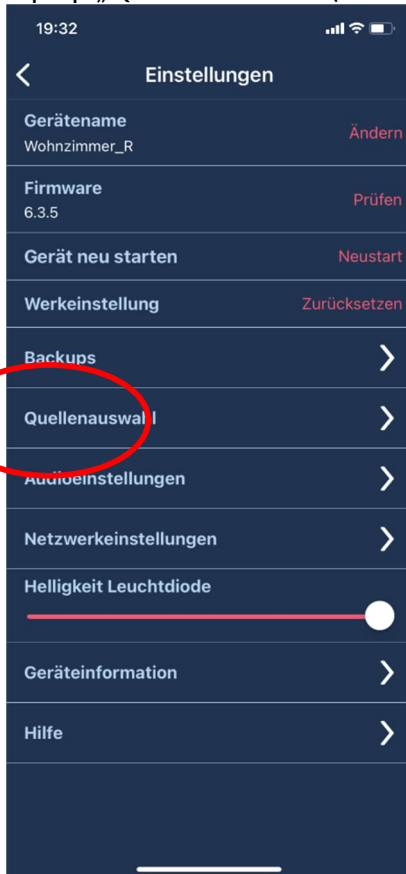

Schakel Airplay, Spotify, UPnP und Bluetooth „OFF“

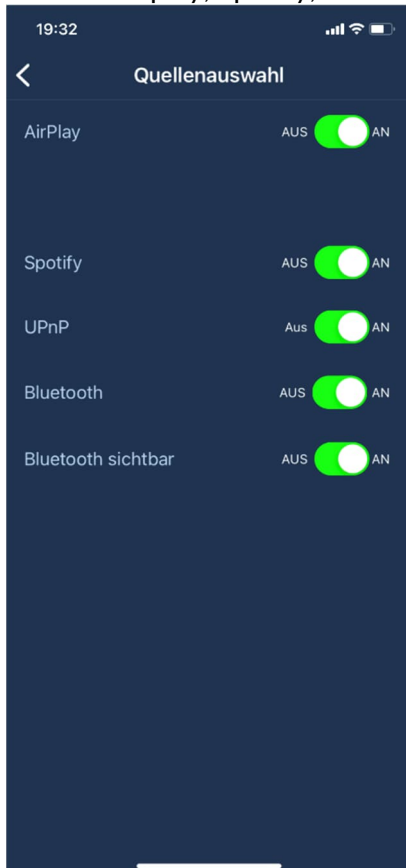

Start het apparaat opnieuw op (reboot device)

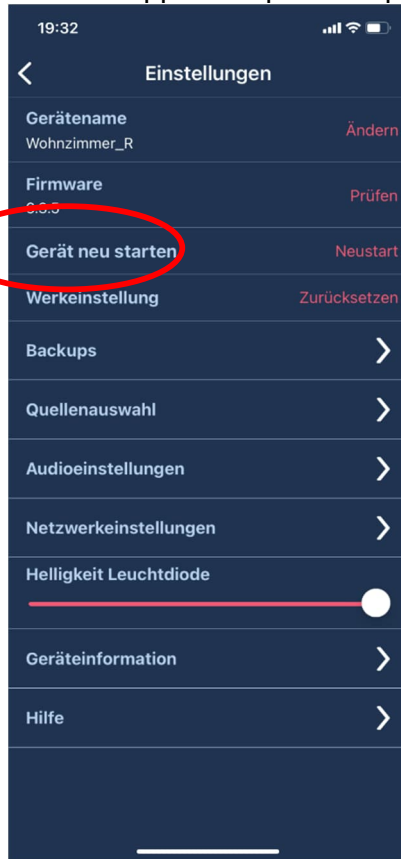

Nu kun je "alleen" internetradiostations afspelen en niemand kan streamen naar de luidspreker / AirBridge via Airplay, UPnP of Bluetooth.

