

POWERBASS-8TB

POWERBASS-8TN

PORTABLE SPEAKER

ALTAVOZ PORTÁTIL

HAUT-PARLEUR PORTABLE

COLUNA PORTÁTIL

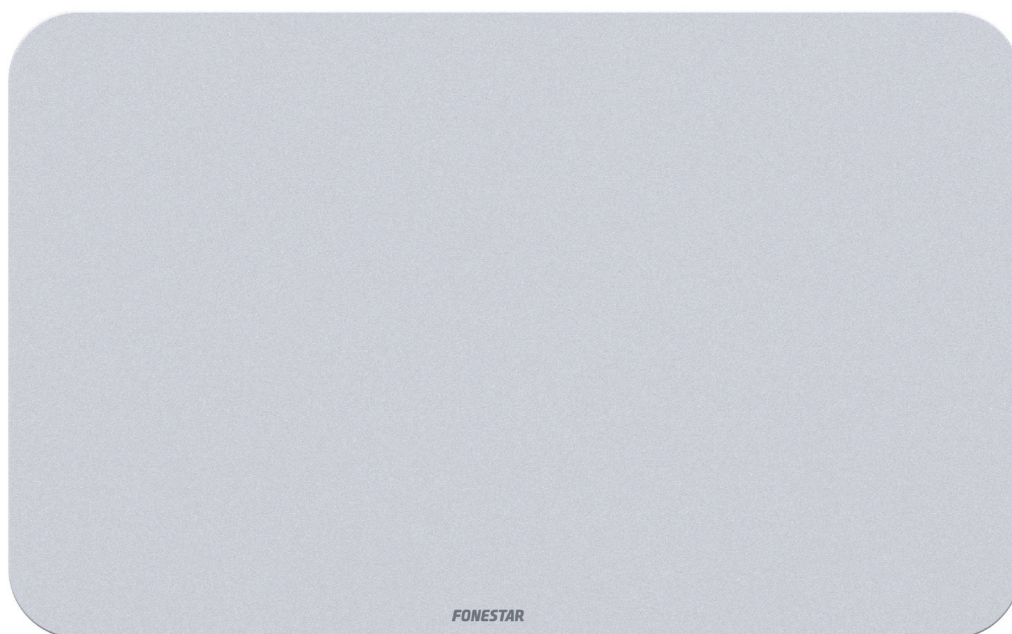

INSTRUCTION MANUAL/MANUAL DE USUARIO/
MODE D'EMPLOI/MANUAL DE INSTRUÇÕES

FONESTAR

DESCRIPTION

- Subwoofer with excellent bass response, for sound reinforcement in ambient music.
- It enhances the bass content of music, delivering deep and powerful bass without distortion.
- Unique FONESTAR design, with stylish shapes and a compact size.
- Several options for transformer power selection and low impedance connection suitable to any installation.
- It incorporates a low-pass filter, which allows its frequency response to be adjusted according to the type of music and the characteristics of the room.
- Bass reflex reinforcement, which uses the rear radiation of the speakers to boost the bass.

CONTROL PANEL

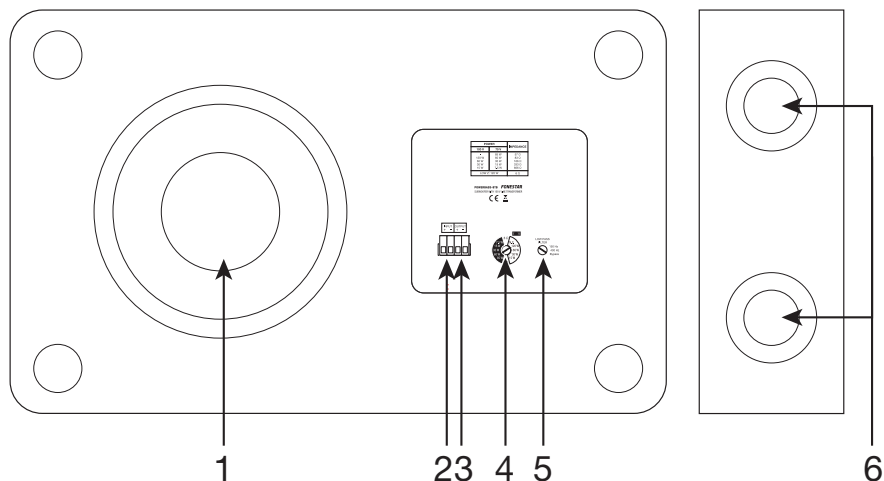

- 1.- Subwoofer speaker.
- 2.- **INPUT**: audio signal input.
- 3.- **OUTPUT**: unfiltered audio signal output.
- 4.- 100V/70V line or low impedance power selector.
- 5.- Low pass filter selector. The subwoofer will reproduce the low frequencies limited by this filter:
 - a.- 150 Hz: 47-300 Hz
 - b.- 400 Hz: 47-400 Hz
 - c.- BYPASS: 47-650 Hz
- 6.- Bass Reflex low frequency reinforcement system.

INSTALLATION

CEILING

- The **POWERBASS-CMB** ceiling mount must be purchased.

FLOOR

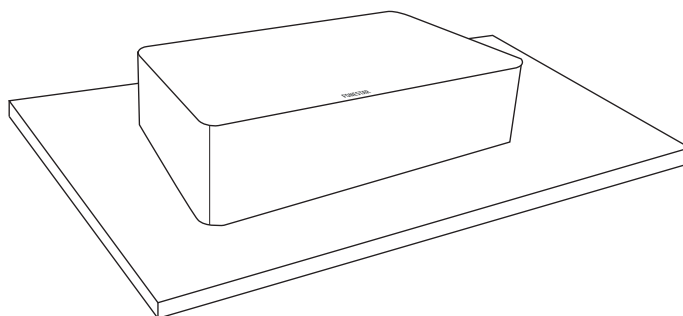

WALL

- 1.- Drill 2 holes with $\text{Ø}7$ drill bit and fit the plugs and screws supplied.

NOTE: the screws must allow for the subsequent installation of the mount, so there must be a gap of approximately 2-3 mm between the wall and the screw.

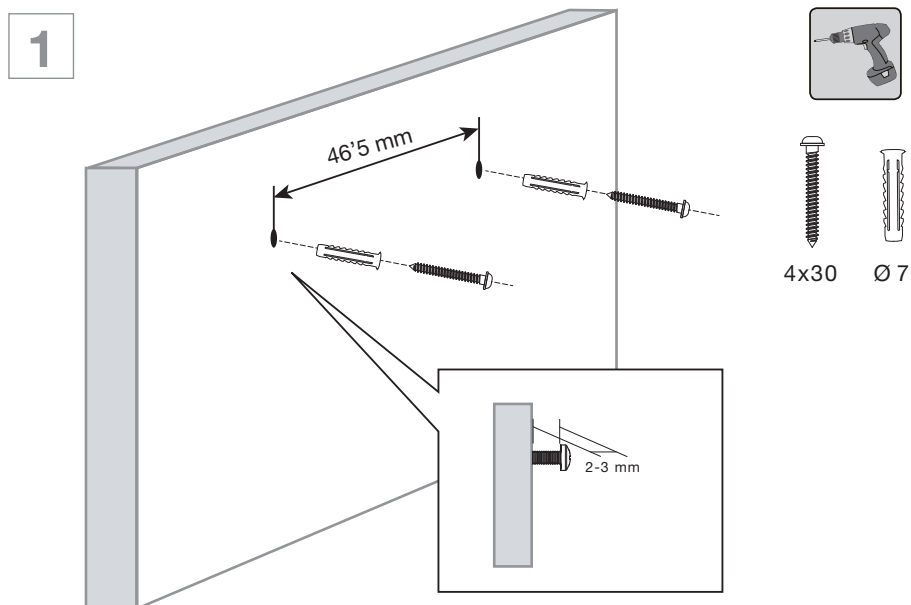

- 2.- Remove the legs at the top and replace them with the wall brackets using the hardware provided.

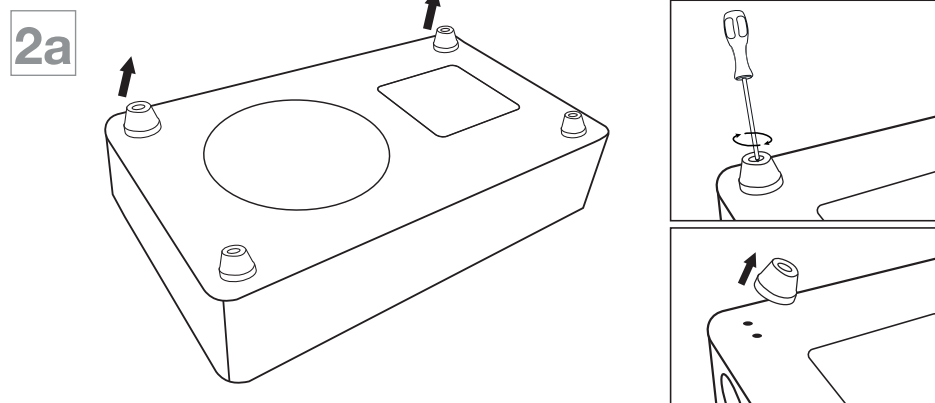

2b

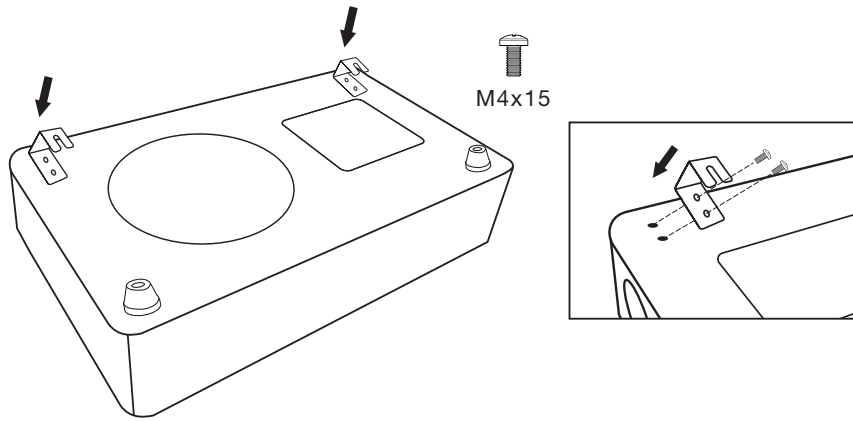

3.- Select the desired power and connect the cables. For more information see the CONNECTION section.

NOTE: connect the cables with the devices disconnected from the mains.

4.- Position the subwoofer by fitting the slots of the 2 brackets into the wall screws.

Make small adjustments on the wall screws until the fixing is firm and secure to prevent it from falling off easily with an accidental knock.

4

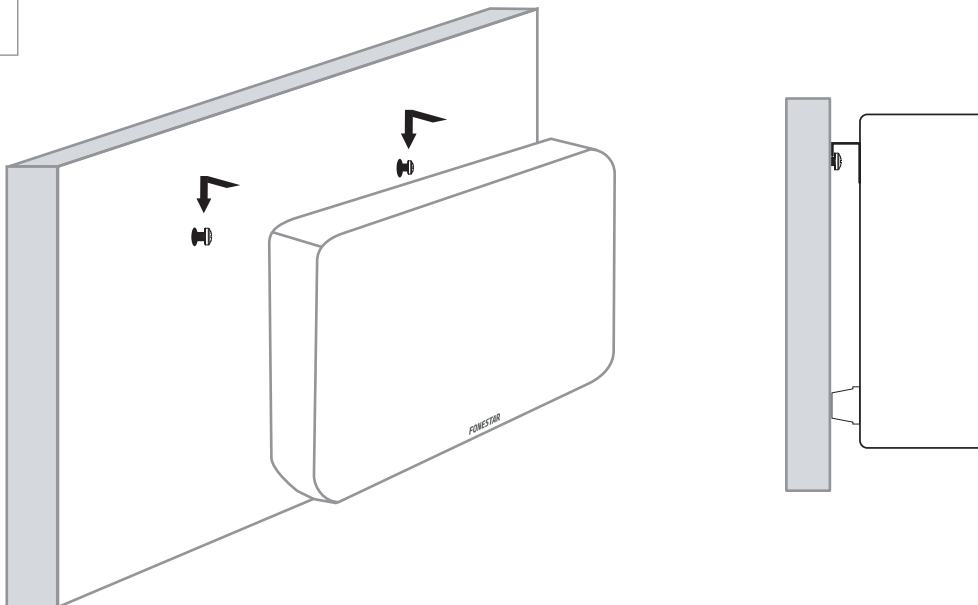

CONNECTION

- With the devices disconnected from the mains, set the desired power setting to high impedance (100 V or 70 V) or low impedance and select the desired low pass filter.
- Connect the audio signal to the subwoofer INPUT; connect other devices to the OUTPUT if necessary.

IMPORTANT: for a correct operation and use of the device's features use the appropriate power, impedance and frequency limits.

- Before proceeding with the connection to other devices, take into account the necessary conditions in a HIGH IMPEDANCE (100 V) and LOW IMPEDANCE installation.

More information can be found at:

fonestar.com/downloads/install_fonestar_es.pdf

- With the volume controls set to minimum, connect the devices to the power supply and turn them on, first the peripherals connected to the amplifier inputs (mixer, recorder, etc.) and then the amplifier.
- Finally, adjust the volume and gain controls on all inputs and outputs until the desired sound is achieved.
- Remember to turn off the device when it is not in use.

CONNECTION EXAMPLES:

HIGH IMPEDANCE

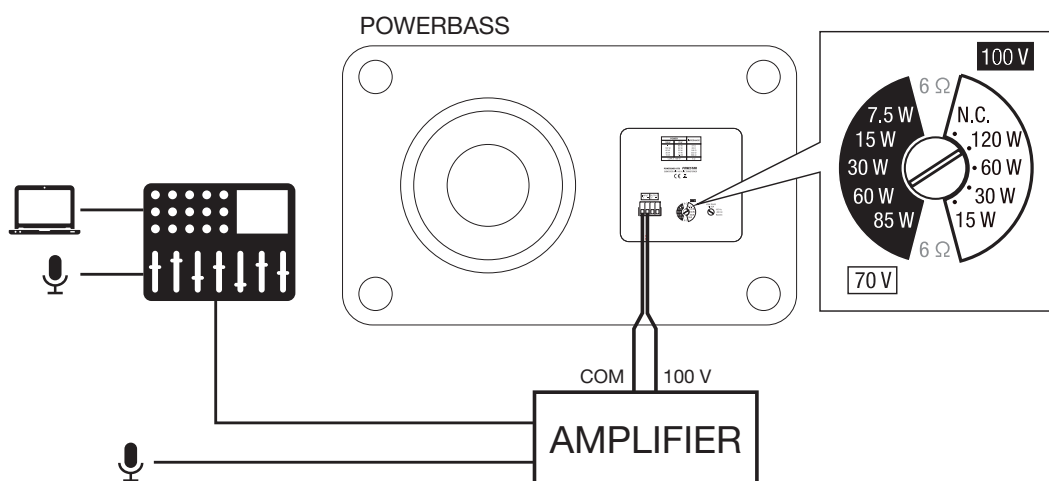

LOW IMPEDANCE

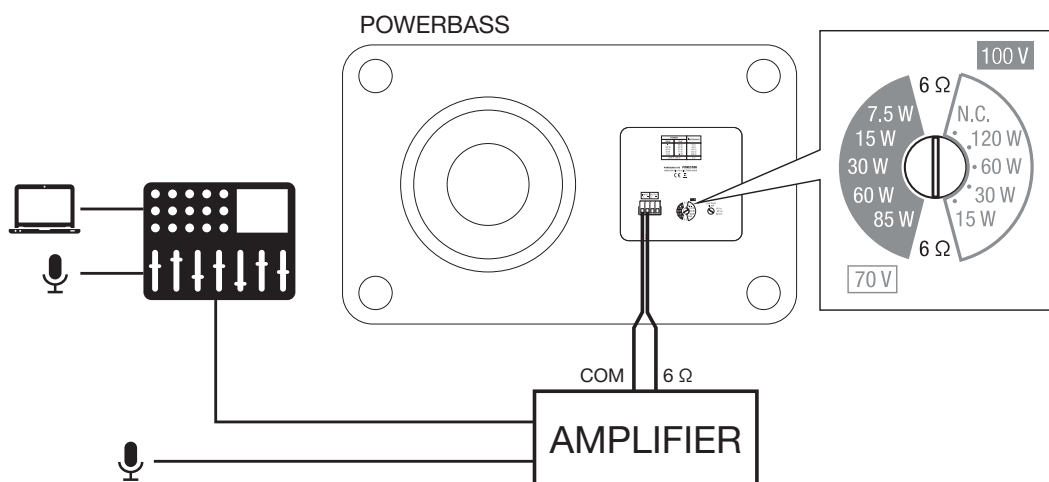

TECHNICAL SPECIFICATIONS

	POWERBASS-8TB	POWERBASS-8TN
FEATURES	Subwoofer speaker for background music applications. Excellent bass response for reinforcement of bass music content. Bass-reflex reinforcement system. Unique FONESTAR design. 100/70 V line driver and low impedance. Wall or floor/shelf installation.	
POWER	120 W RMS (IEC 60258-5 Average rated power, 100 hours)	
LOUDSPEAKERS	1 x 8" woofer	
RESPONSE	47-300 Hz (-10 dB) @ FPB 150 Hz 47-400 Hz (-10 dB) @ FPB 400 Hz 47-650 Hz (-10 dB) @ Bypass	
IMPEDANCE	120 W RMS@100 V (83 Ω) 60 W RMS@100 V (166 Ω) 30 W RMS@100 V (333 Ω) 15 W RMS@100 V (666 Ω) 85 W RMS@70 V (57 Ω) 60 W RMS@70 V (83 Ω) 30 W RMS@70 V (166 Ω) 15 W RMS@70 V (333 Ω) 7.5 W RMS@70 V (666 Ω) Low Z: 6 Ω	
SENSITIVITY	85 dB @1 W/1 m	
SOUND PRESSURE	103 dB @ rated power/1 m	
SWITCH	W selector in high Z and low Z Low pass filter selector: 150 Hz / 400 Hz / Bypass	
MATERIAL	MDF	
CONNECTORS	Euroblock input and output	
TEMPERATURE RANGE	Operation: -10° ~ 50°C Storage: -20° ~ 50°C	
DIMENSIONS	545 x 150 x 337 mm depth	
ACCESSORIES	Wall mounting brackets Screws and mounting accessories	